

# Muirhead Springs Forest Preserve

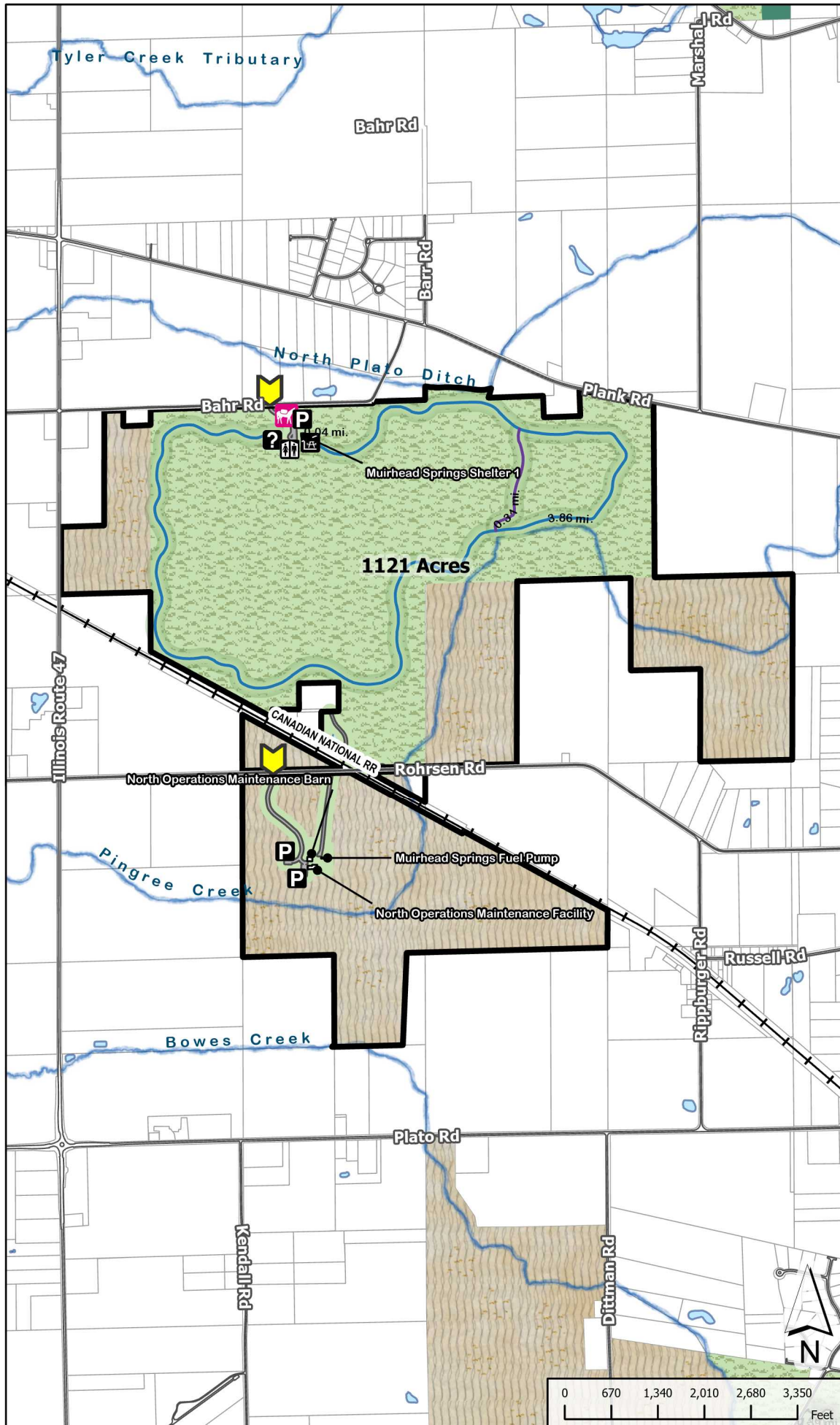

- Entrance
- Model Aircraft/Drone Field
- Equestrian Area
- Off-Leash Dog Area
- RV Campground
- Camp Sites
- Kiosk
- Parking
- Shelter
- Restroom
- Forest Preserve Road
- Forest Preserve Boundary
- Cropland
- Grassland
- Mowed Land
- East Cutover Trail, Asphalt
- Grand Prairie Loop Trail, Asphalt
- Shelter Access Trail, Asphalt
- Kane County Bike Trails

42W797 Rohrsen Rd  
 Hampshire, IL 60140

Information: (630) 232-5980  
[www.kaneforest.com](http://www.kaneforest.com)  
 Hours: Daily, Sunrise-Sunset

Updated 1/24/2023

